

Kysor™ K26RA On/Off Fan Clutch for Heavy-Duty Truck Applications

With Kysor On/Off Fan Drives from BorgWarner Thermal Systems, the fan continues to rotate even if the clutch stops working. In the event of air system pressure failure, the fan remains engaged which prevents the engine from overheating. These drives have fewer moving parts and an innovative design that improves belt life and provides for easier maintenance—and less of it. With proper maintenance, a million miles of trouble-free service under normal operating conditions may be expected. Greater dependability keeps you from worrying about costly breakdowns.

The new K26RA offers increased torque to meet today's higher engine cooling demands and, like its predecessor, the K22RA, provides easier maintenance, better reliability, and greater customer satisfaction.

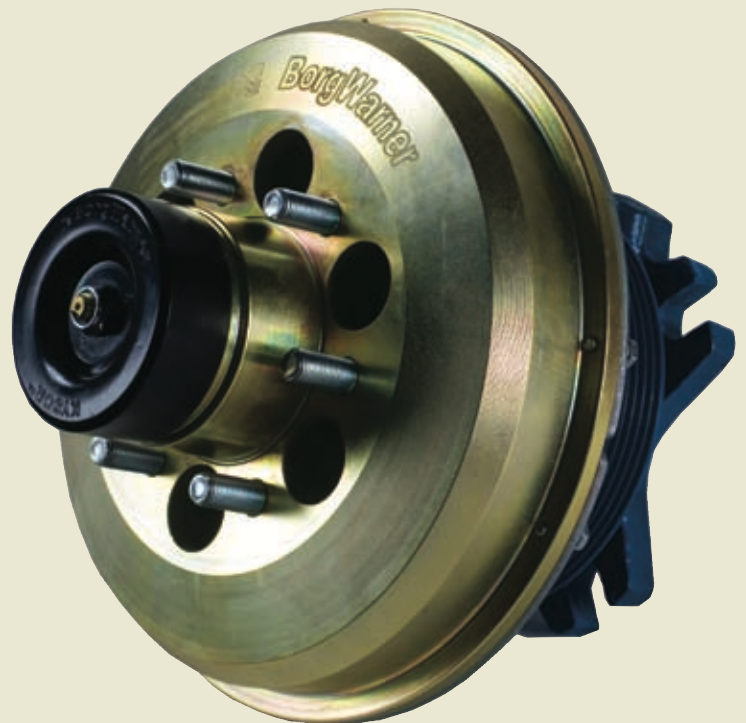

BorgWarner Thermal Systems is a single point of contact for cooling system components for passenger car, SUV, light truck, medium-duty truck, heavy-duty truck, and off-highway applications. We work with original-equipment manufacturers around the world to provide a full range of direct-actuated Viscronic® fan drives, viscous fan drives, Kysor™ on/off fan clutches, Cool Logic™ heavy-duty multi-speed drives, polymer fans, and shutters.

cool
FAN CLUTCHES

Kysor™ K26RA On/Off Fan Clutch

Higher Performance, Lower Maintenance, Greater Dependability.

Features	Advantages	Benefits
Powerwedge™ clutch liner	Consistent performance & dependability	Longer time between liner change
Dynamic torque capacity	Improved cooling capability	Meets requirements for all new engines since 2002 as under hood temperatures continue to rise
Hub bearing design	Product durability & reliability provides better overall performance	No unnecessary & costly service issues
Modular clutch design	One clutch for all applications	Easier to service, saving time & reducing maintenance & inventory costs
Fail Safe™ design	Provides continuous cooling	Assures reliable operation preventing costly breakdowns

Vehicle	Engine	Data Book Code
Freightliner	All	273-019
Kenworth	Cummins M11	1107105
	Cummins ISM	1107106
	Cummins NTC/N14	1107115
	Cummins ISX/Signature	1107120
	Caterpillar C10/C12	1107306
	Caterpillar 3126	1107330
	Caterpillar 3406/C15/C16 Detroit Diesel Series 60	1107355 1107540
International	All	12TKN
Mack	Mack E7	1180050
Peterbilt	C10/C12/C15/C16	2617020
	Detroit Diesel Series 60	2627030
	Cummins ISM	2627040
	Cummins N14	2627050
	Cummins ISX/Signature	2627080
Sterling	All	273-019
Volvo	All	208-012
Western Star	Cummins ISM	304-031
	Cummins N14	304-032
	Caterpillar C10/C12	304-033
	Detroit Diesel Series 60	304-034
	Caterpillar 3406C	304-035
	Caterpillar 3406E	304-036
	Caterpillar 3306	304-037
	Cummins Signature	304-040
	Cummins ISC	304-041

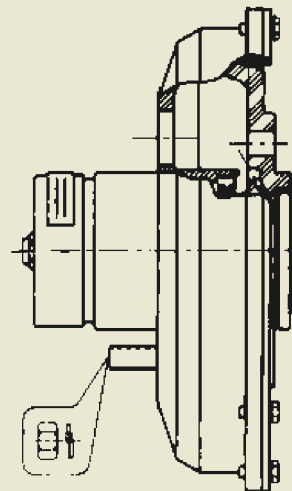
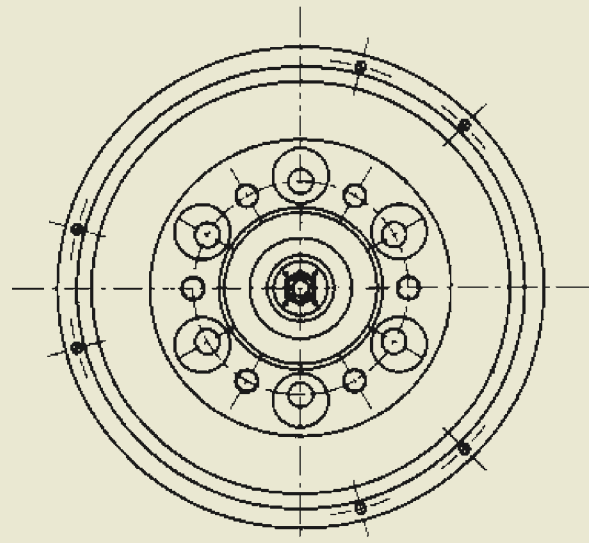

Worldwide Technology Centers

1507 South Kalamazoo Avenue
Marshall, MI 49068 USA

Planckstrasse 4 + 6
D-88677 Markdorf Germany

www.bwthermal.com



BorgWarner
Thermal Systems